



**Kühl**<sup>®</sup>  
Stylish Fans

BLDC  
FAN

ENERGY  
EFFICIENT

LOW  
NOISE

# Kühl BRISE Series

STYLISH FANS FOR MODERN HOMES



User Manual

# Welcome to **Kühl**

Dear Customer,

Thank you for choosing **Kühl Stylish Fans**! It is indeed a wise decision as **Kühl Stylish Fans** are based on the New Technology named BLDC that offers energy efficient and low noise operation. This feature not only helps to keep the room cool but also keeps the electricity bill in check. The fans operate at a high speed and without noise. We believe in customer satisfaction as each **Kühl Stylish fan** is delivered to you after going through an extensive and complete series of testing procedures that examine every area of its operation, effectiveness, and efficiency under various working situations.

**Kühl Stylish Fans** are here with everything you need from a fan and much more to give you all-round performance. With 1/3<sup>rd</sup> energy consumption, it is a pioneer in energy efficiency and brings you world class comfort. It's time to say goodbye to high electricity bills and be a part of the smart future.

Thank you!

Kühl Stylish Fans

## Table of contents

1. Introduction.....	1
2. Features of Kühl Brise Stylish Fan.....	1
3. Items in the Box .....	2
4. Know your Remote Control Device.....	3
5. Power Saving & Energy Efficient Guide.....	4
6. Cost Saving Guide.....	4
7. Mounting Recommendations & Maintenance .....	5
8. Safety Guidelines .....	5
9. Assembly Instructions .....	6-14
10. How to operate Kühl Brise BLDC Fan .....	14
11. How to Operate Remote Control Device .....	15-16

# Introduction

Style has never been defined in a better way than the Kühl Brise Series Fans that not only enhances the style quotient of your home but also makes it more awe-struck than ever. Designed to make your space more aesthetically pleasing and stylish, they are designed with a classy combination of stylish finish and new-edge features. Despite their stylish appearance, Kühl Brise Fans work only on 30-35 watt as against heavy 80-W induction fans. The series includes Kühl Brise E3, E4, and E5 that are not just functionally powerful but also beautiful, making them a must to enhance the aesthetic appeal of your home.









## Features of Kühl Brise Stylish Fans

1. **BLDC Technology for Energy Saving:** Kühl Stylish Fans offer better speed versus torque characteristics. It ensures high dynamic response and efficiency. Thanks to its lack of electrical and friction losses, it offers long operating life and ensures one more step towards building a sustainable future.
2. **Highest Air Delivery:** Energy efficient operation with around 30-35 W Power, 1400 MM Sweep, & high RPM Speed to fill every corner of your place with fresh air as per your need. Its higher air force ensures unmatched comfort to every corner of the place.
3. **Low Noise:** A low noise operation without compromising speed limit is one of most desired features of Kühl Stylish Fans. They operate at low speeds while providing high air flow with low turbulence and minimal wind noise.
4. **One Fan, Many Operations:** Kühl Stylish Fans are IoT-enabled, making it highly efficient and easy to use. Conveniently set to adjust the fan speed, lighting preferences, different modes, set timer, and a lot more via:
  - Remote
  - Voice Enabled Devices, such as Alexa, Bluetooth
  - Smartphones
  - Alexa

- 6. **Aerodynamic Blades:** Aerodynamic design helps deliver higher airflow and low noise at a low wattage.
- 7. **Reverse Mode:** During winters, when hot air gets stuck at the top of the ceiling, you can switch on the reverse mode for air circulation, so you can feel warm air consistently spread across the place.
- 8. **Attractive Design:** Stylish enough to enhance the look of your place, Kühl Stylish Fans feature decorative trims and a sleek surface that become the centre of attention in any space.
- 9. **5 Star Rated:** All Kühl Stylish Fans are 5-Star Rated that helps bring down the power consumption, thus, saving a lot of energy and money.

SPECIFICATION	Kühl Brise E5	Kühl Brise E4	Kühl Brise E3
Power (Watt)	30	35	35
Sweep (mm)	1400	1400	1400
Air Delivery	235	232	232
Speed in RPM at 5 <sup>th</sup> position	188	204	216

## Items in the box

Fan Motor Unit	1 N	
Canopies	2 N	
Down Rod	1 N	
Shackle	1 N	
Down Rod Bolt	1 N	
Blades	3/4/5 N	
Fan Remote	1 N	
Pencil Cell AAA	2 N	
Supply Wires	1 N	
Warranty Card	1 N	

# Know your Controller

## • Remote

1. **SPEED SETTINGS:** Speed varies for five different levels, wherein S1 is the lowest fan speed and S5 is the highest. Press as per your requirement.
2. **SLEEP MODE:** Auto speed control for uninterrupted comfortable sleep. Select this setting before going to bed, and the speed will automatically drop to the minimum pace you specify. This function is available through the KÜHL Fan's App.
3. **BUILT-IN TIMER:** You can use timer settings for 1 hour, 4 hours, & 8 hours accordingly.
4. **BOOST MODE:** Press this button to accelerate the fan past its maximum speed directly when it's too hot.
5. **REVERSE MODE:** When you put the fan into reverse, it draws air upward. This brings the warmer air near the ceiling back down into lower half of the room, where the people are. This function is available through the KÜHL Fan's App.



## • IoT/Wi-fi

**Please follow the given steps to connect KÜhl fan to Wi-Fi Network:**

- Use a Paired Remote
- Switch ON Fan
- Press & hold "Boost" button
- On remote for 10s, 2 Beeps indicate success
- Use KÜhl mobile app for Wi-Fi Pairing

## • Voice command/Alexa

**To set up Alexa:**

Simply link your Amazon/Alexa account to the KÜhl mobile application to setup Alexa with your KÜhl fan.

# Power Saving & Energy Efficient Guide

Kühl Stylish Fans come with revolutionary and super energy-efficient BLDC motor technology that consumes less energy. Our fans consume only 1/3<sup>rd</sup> of the power consumed by ordinary fans. Kühl Stylish Fans run on just 30-35 watt at full speed whereas ordinary induction fans run on approx. 80 watt.

## Cost Saving Guide

	Induction Fans	Kühl Brise Fans (E5)	Kühl Brise Fans (E4, E3)
Power consumption	75 W	30 W	35 W
Assumed usage of fan per day (hours)	16 h	16 h	16 h
Power consumption – KWh Units per day	1.2 kWh	0.56 kWh	0.64 kWh
Electricity bill per day @ Rs 7/unit	Rs 8.4	Rs 3.92	Rs 4.48
Electricity bill per annum	Rs 3066	Rs 1430.8	Rs 1635
Savings per annum	-	Rs 1635.2	Rs 1431
Cost saving (Up to)	-	53%	47%

## Mounting Recommendations & Maintenance

1. A minimum height of 2.3 meters above the ground is required for the fan's mounting. Allow enough room from the ceiling for the high-level cabinet doors to open. At least 0.25 meters should separate the blade from the ceiling.
2. The horizontal distance from the nearest wall to the blade tip should be around 0.5 times the fan sweep, for example, from 1200 mm, it should be 600 mm.
3. There should be a minimum clearance of 2 times the fan sweep between the centers of two fans, for example, 1200 mm should be 2400 mm.
4. Turn the fan off before cleaning, to prevent any harm or damage. Be extremely cautious while working around the fan. There is no additional type of maintenance needed except routine dusting. To prevent scratches, use a soft brush or a lint-free cloth. Avoid using solvent, abrasive, or hard detergent.
5. To prevent the fan from wobbling or dropping, never exert too much power while cleaning the blades. To prevent any inconvenience, frequently check that the nuts, bolts, screws, and washers are in correct position.

## Safety Guidelines

Read the safety guidelines carefully to understand the installation, use, and maintenance.

1. Never place any part of the packaging within the reach of children/differently abled.
2. Avoid using moist or damp hands while switching On/Off this appliance.
3. Before cleaning and doing other maintenance procedures, be sure to turn off the fan's power supply.
4. To prevent mishaps, it is advised to inspect the suspension system of the ceiling fan every six months to ensure that the fasteners are properly tight.

## Assembly Instructions Kühl Brise Series Fans

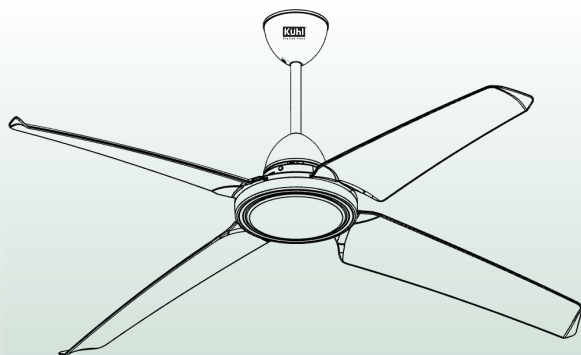



## Step 1. Open Blade screws

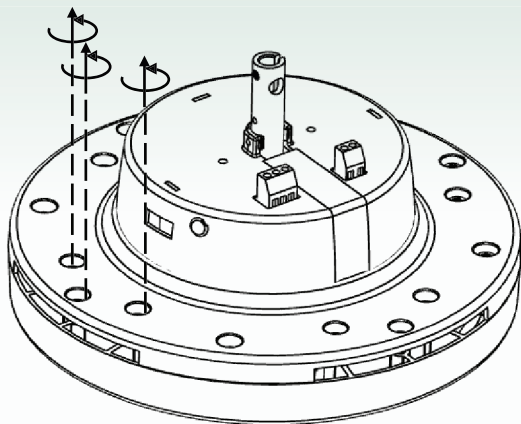

Place the Motor unit over a towel on a table, and open the 4 Blades and Screws as shown

## Step 2A. Assemble 1st Blade

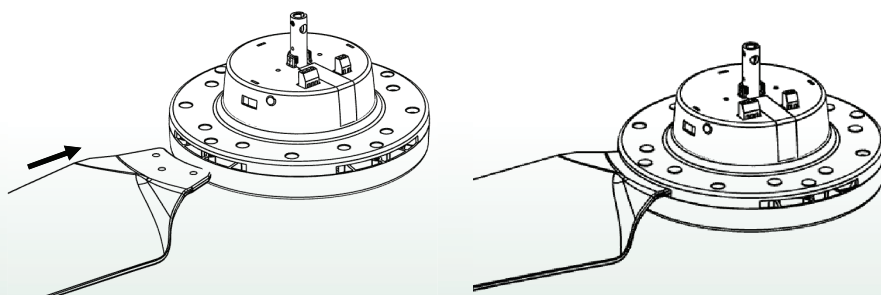

Bring the 1st Blade towards the fan motor, and align with the blade holes on the motor unit

## Step 2B. Assemble 1st Blade

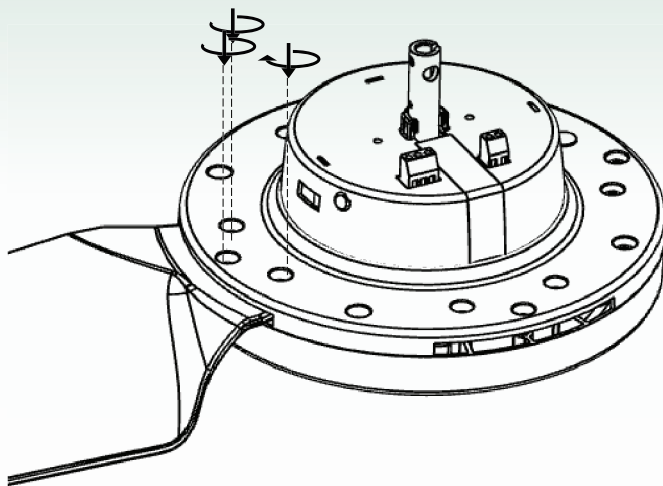

Re-insert and fasten the 2 screws

## Step 3. Assemble all 4 blades

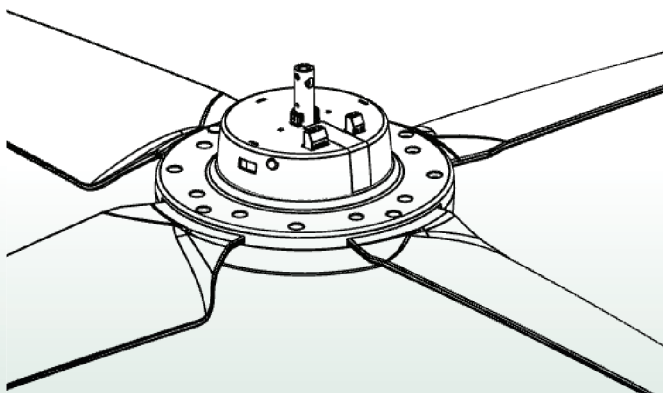

In a similar manner as done for the 1st blade, assemble the other 3 blades

## Step 4. Down Rod Installation

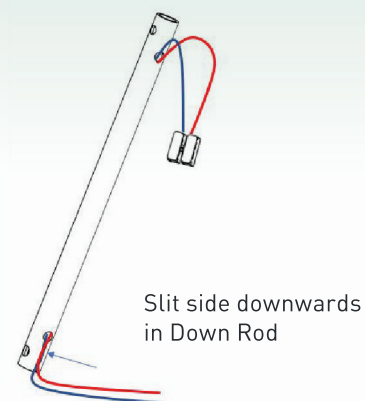

Take the Down Rod with  
pre-inserted supply wire

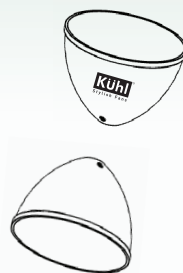

Also bring the Canopies

## Step 5. Insert Canopies over Down Rod

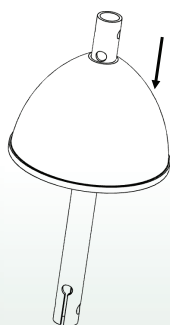

Insert smaller  
Canopy from Slit-end  
of Down Rod

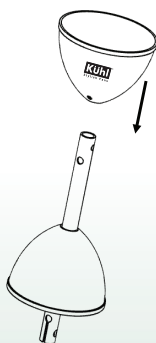

Insert bigger  
Canopy also from  
Slit-end, as shown

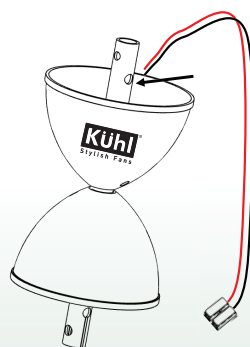

Raise bigger Canopy and  
tighten the Canopy screw  
to hold it in place

Down Rod Bolt

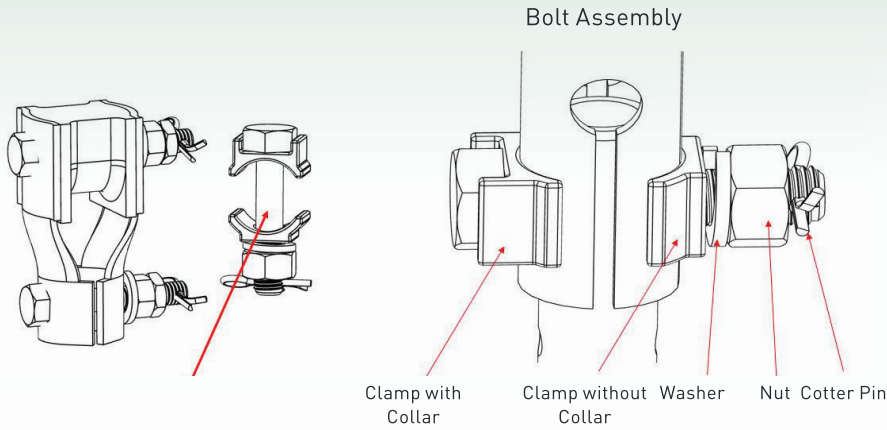

Take the Down Rod Bolt from the Shackle kit

Step 6A. Down Rod Assembly

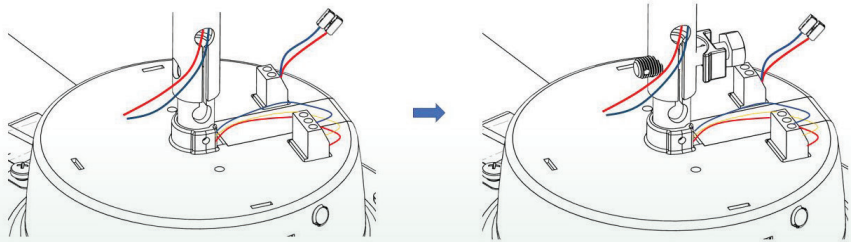

Insert Down Rod slit-end down over Motor Shaft

Insert Down Rod Bolt with Collared Clamp

Bolt Assembly Sequence

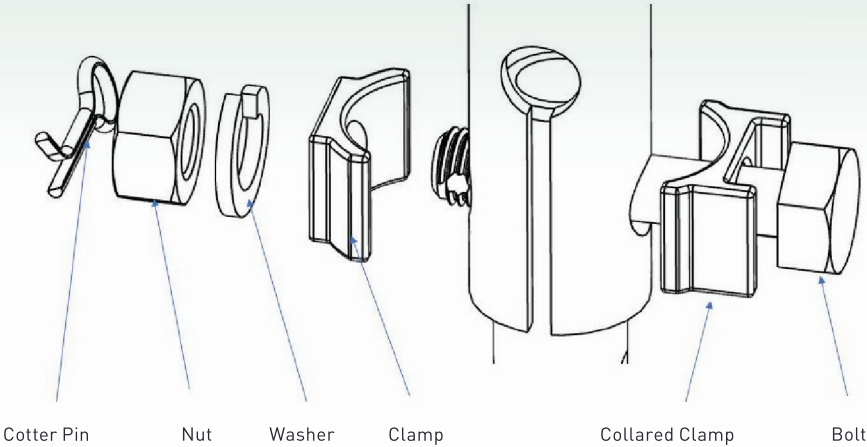

Step 6B. Down Rod Assembly

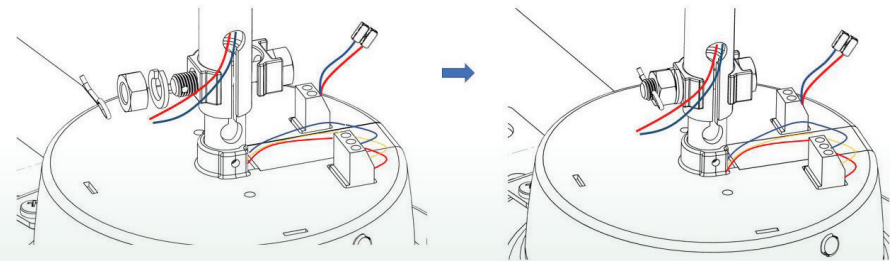

Fasten the Down Rod bolt as shown

Down Rod bolt fastened

## Step 7. Make Electrical Connections

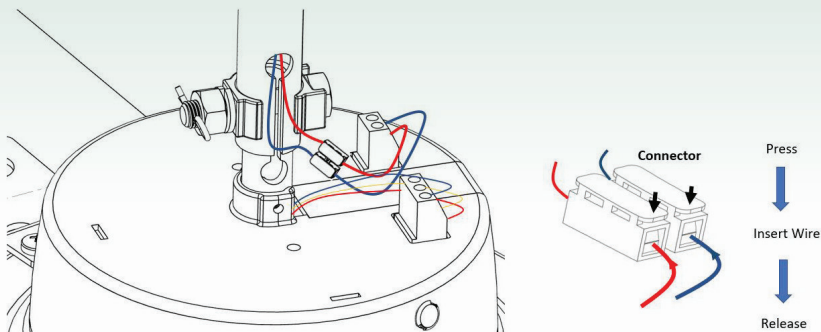

Connect the Supply wire from  
Down Rod into Link Wire connector

Wire Connection Method

## Step 8. Bring Lower Canopy Down

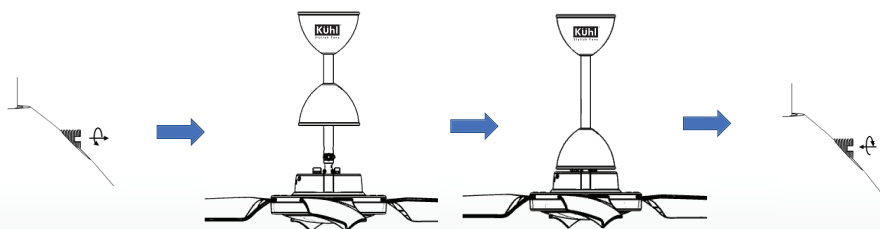

Loosen The Screw and  
Bring the lower Canopy down

Fasten back the Screw to  
lock the canopy in position

## Step 9. Open Lower Bolt from Shackle

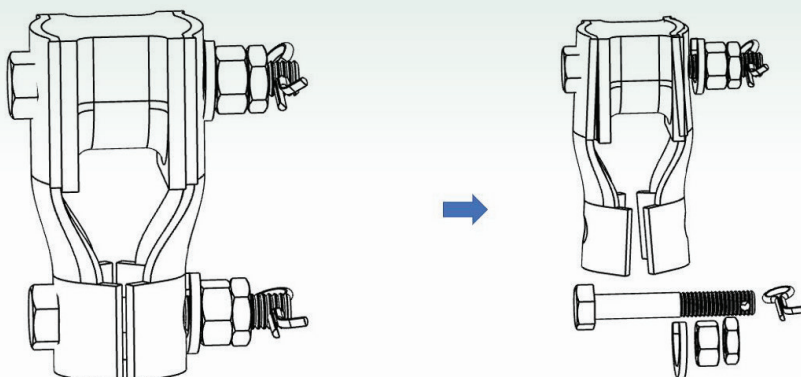

## Step 10. Install Shackle and Hang the Fan

Insert Shackle  
into Ceiling Hook

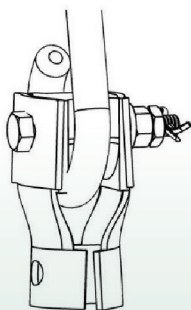

Raise Fan  
to Shackle

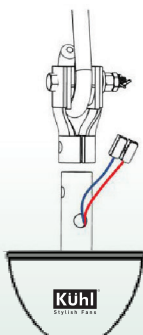

Re-insert  
Lower Bolt

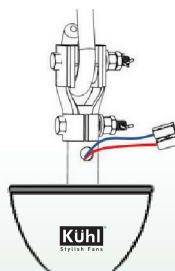

Tighten with Washer, Nut, Lock Nut  
and Cotter Pin in sequence as written

## Step 11. Connect to Electric supply

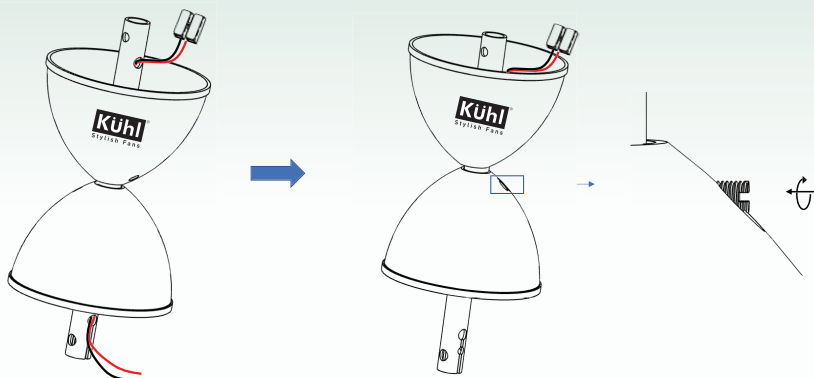

Connect the wires from main supply into fan connector

Raise the upper Canopy and tighten the Canopy screw

## Assembly and Installation complete

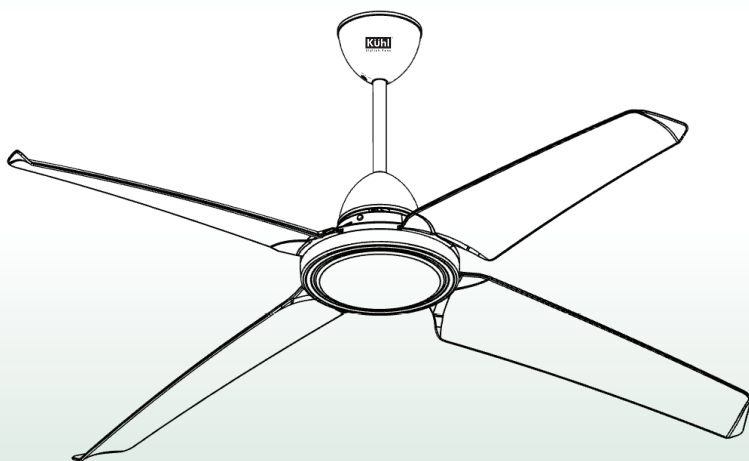



## How to operate Kühl Brise BLDC Fan

### Important Instructions regarding Regulator:

- Fan regulator is not required for this BLDC fan because it is operated by remote. It also operates on Smart Phone, Alexa, & Voice-enabled devices.
- You should ask your electrician to bypass the Regulator in Switch Board wiring. Otherwise, fan may not operate properly.
- If Fan wiring is already through a Regulator in switch board, then make sure that Regulator is always set at max speed, and any change in speed should be done by Remote



## How to Operate Remote Control Device

### Get the Remote ready.

- Insert 2 AAA Batteries into the Remote Unit's slot provided at the back.
- Switch ON the fan from switch board to operate it with Remote as explained hereafter.

### Pair the remote with fan, if not paired already

- Press Power button on Remote to start BLDC Fan
- In case the fan starts running, your Remote is already paired
- However, if the fan does not run, the remote requires pairing with Fan. Do the following to pair the remote with fan:
- Switch OFF the fan from switch on the wall, and Switch it ON again
- Within 45 sec of switch ON, press the POWER button on Remote and keep it pressed for 10 sec. You'll hear a double beep. The fan is now paired and can be operated with remote.



## Power ON/OFF Button

- Press Power button on Remote to start BLDC Fan
- Beep sound will indicate that it is switched ON.
- Press power button again to switch off / on the BLDC Fan.
- BLDC fan always re-starts at last Switch OFF speed.
- In case there is a power failure, the fan will automatically restart at previous speed
- If you want to switch off the fan during power failure, you must switch it off from the Main board switch in wall, as remote is not operational without Power.
- It is recommended to Switch off the fan from wall mounted switch when going out of home.

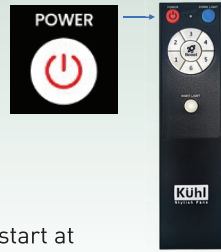

## Speed Buttons

- Kühl Stylish Brise fans comes with five different speed settings from slowest (1) to fastest (5). To vary speed, press SPEED button (1 to 5) on Remote. A beep will confirm the action.
- Upon Switching On after a switch off, the fan will restart at same speed it was running before the switch off.



## Boost Button

- If you want to run this fan at maximum speed Press BOOST button on Remote. A beep will confirm the action.



# All Kühl BRISE Fans are 5- Star Rated By BEE

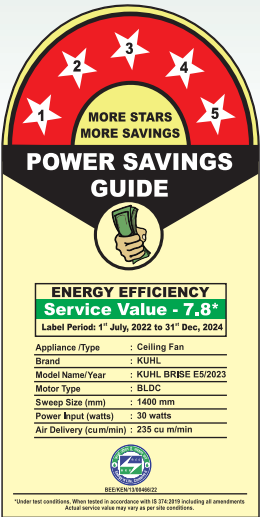

Kühl BRISE E5

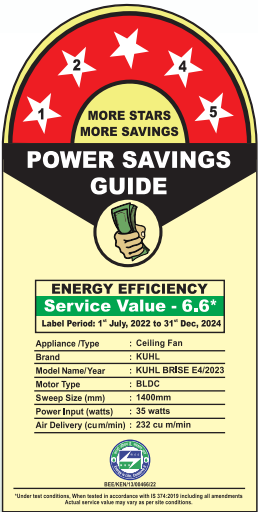

Kühl BRISE E4

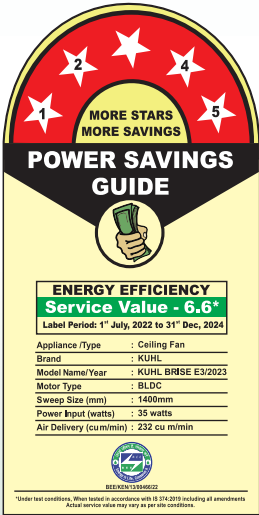

Kühl BRISE E3



**CONTACT US AT:**

E-6,7 & 8, Sector-59, Noida, U.P.-201 309, India. Call: 92-789-12345  
E-mail: [service@kuhl.in](mailto:service@kuhl.in) or visit us at [www.kuhl.in](http://www.kuhl.in)